

# Monidor Solution, Quick guide

## Basic use

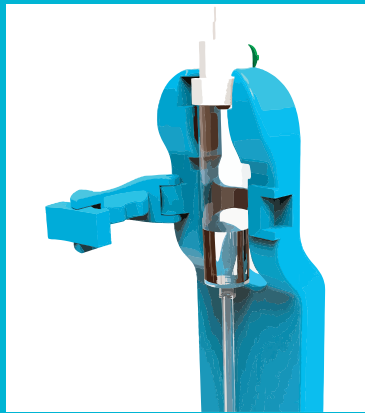

Start the device by pressing the power button.



Attach the Monidrop device to the drip chamber.



Use the roller clamp or the fluid regulator to set the infusion rate.

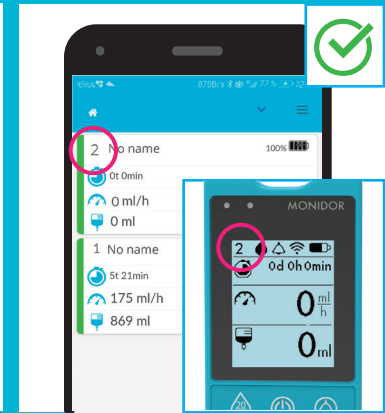

You use the device numbers to identify your Monidrop and IV Screen card.

## Advanced settings and notifications

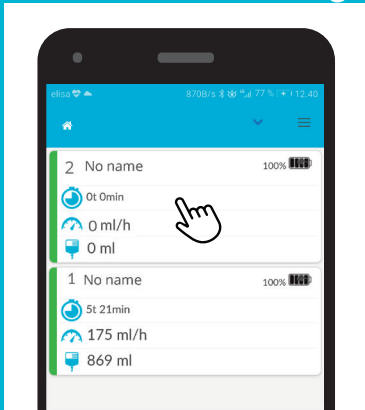

If you wish, you can make additional settings by clicking on the device card you are using.

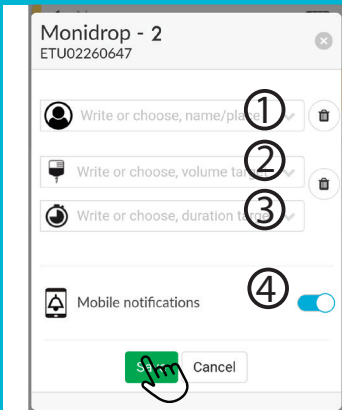

Insert the patient position (1), limits for liquid volume (2) and duration of treatment (3) or activate phone notifications (4).

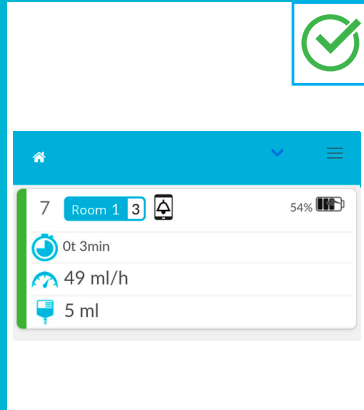

The treatment is progressing as planned, when the card is displayed in the IV Screen in green.

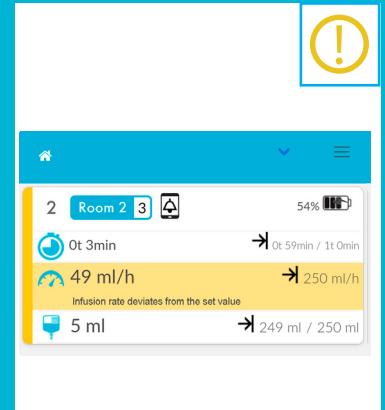

During treatment the deviations that occur are displayed as a yellow card, and the reason for the notification is highlighted in yellow.